

# TECHNICAL DATASHEET



## EF END CAP

00 Update - 01/2024

### TECHNICAL DATA

Article No	001 117 2140 0020
d (mm)	20
D (mm)	32
L (mm)	64
le1 (mm)	55
m (mm)	25,5
Weight (Kg)	0,040
Box Quantity (pcs)	100
Box Dimension (cm)	34,5x34,5x26

### INJECTION MOULDED

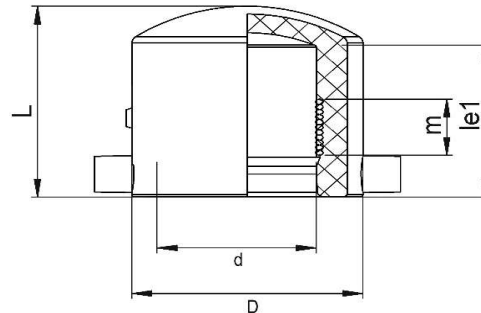

### IDENTIFICATION OF PRODUCT

D(mm)	20
SDR	11
RAW MATERIAL	PE 100
PRESSURE CLASS	16 Bar Water 10 Bar Gas
TRADEMARK	NTG
EXECUTION	Injection Moulded
STANDARD	EN 12201-3 EN 1555-3 AS / NZS 4129
SPECIFICATION	Suitable for SDR9...11 pipe 4 mm pin connectors

### EF SPECIFICATION

WELDING VOLTAGE	40V
RESISTANCE	10,70Ω
WELDING TIME	35 Sec.
COOLING TIME	5 Min.
WINDING TYPE	Monofilar
WELDING BARCODE	



961420300202401075035118

Tolerance on diameters and thickness according to the standards. The other dimensions are specialized. Tolerance  $\pm 5\%$ . NTG PLASTIK reserves all the right to change any information without giving prior notice. The production, distribution and utilization of this document without explicit authorization is prohibited.

Fr 161 Rev 00